

Traffic Mirror

Public use



- This mirror can be used on public roads: it must be installed in urban areas.
- Comply with traffic sign legislation - Decree of 21/09/1981 - art. 14
- Wall fixing by the means of a wall bracket (wall screws not supplied)
- Possibility of fixing the mirror on a post (fixing flange not supplied)

Technical Description

- *Frame material: white screen-printed extruded PVC panel*
- *Mirror material: poly mir (no expansion)*
- *Viewing distance : less than 15 m*

Article Code

Frame 60 x 45 cm
Mirror 40 x 30 cm
Weight : 3,92 kg

Art. Code : B319PPV
EAN Code : 3234640052021

Frame 60 x 60 cm
Mirror Ø 40 cm
Weight : 3,60 kg

Art. Code : B319P60PV
EAN Code : 3234640052038

Frame 85 x 51 cm
Mirror 56 x 34 cm
Weight : 4,20 kg

Art. Code : B319POVAPV
EAN Code : 3234640052045

- Extract from the 21/09/1981 decree regulating the installation of a road mirror in urban areas:
In built-up areas, the mirror can be used provided that the following conditions are met:
 - Implementation of a priority system; with obligation of a STOP panel / strip for the user
 - Distance between the stop strip and the mirror less than 15m
 - Speed limit on the priority road less than or equal to 50 km / h
 - Installation at more than 2,30m in height
 - Mainly local traffic on the road where the STOP panel / strip is located

B319P60POVAPV - B319P60PV - B319POVAPV

NOTICE DE MONTAGE / FITTING INSTRUCTION

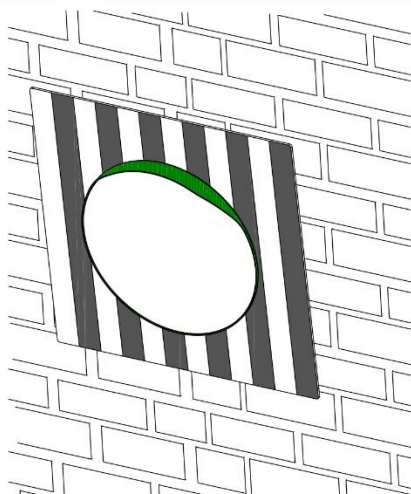
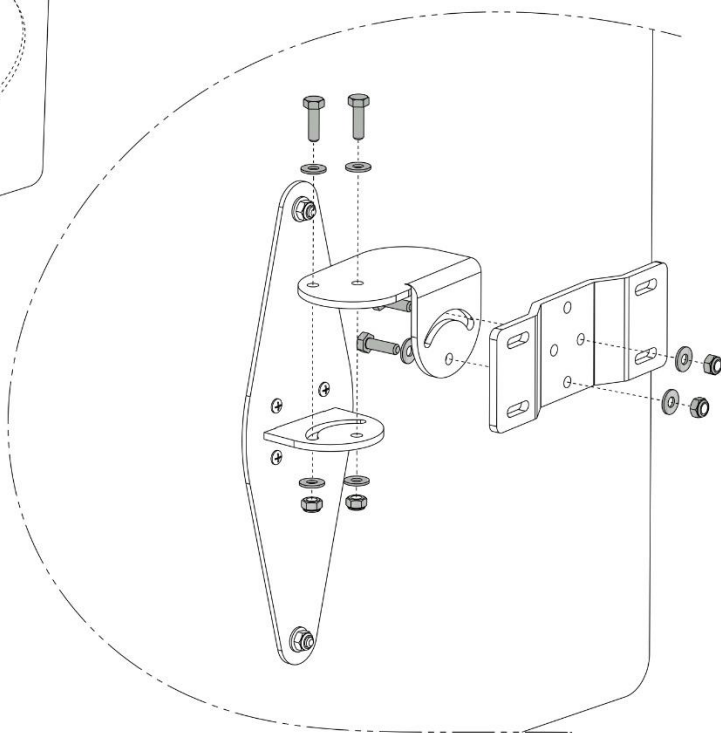
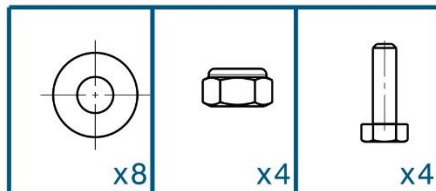
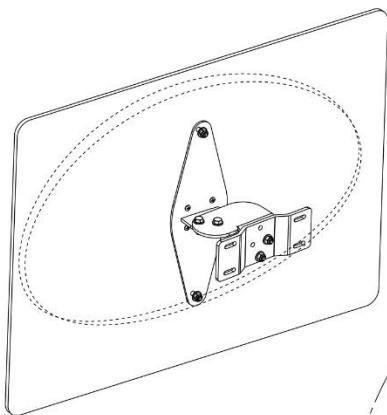

POSE MURALE
/WALL MOUNTING

OU
/ OR

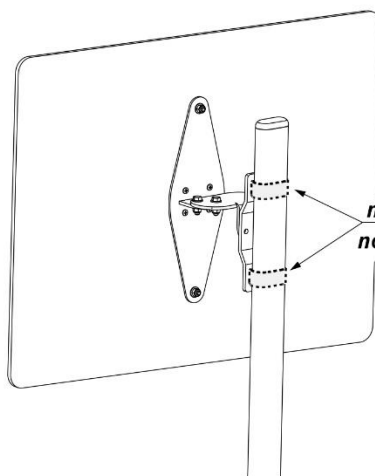

non fournis
not included

SANGLAGE METALLIQUE
/ METAL STRAPPING

CONB319 22 136